



Le Deun
LUMINAIRES

MADE IN PARIS

Suspension Fitting system "Cascade"

Mode d'emploi - *Instructions*



1

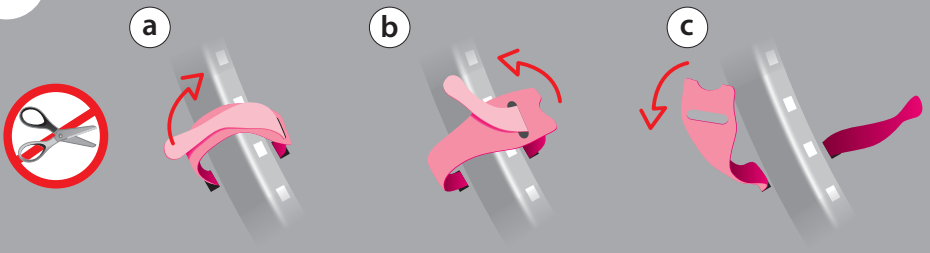

2

Pour les lampes de 150 à 300 cm
For lights from 59 to 118 inch

**Montage à plat !
Flat mounting only!**

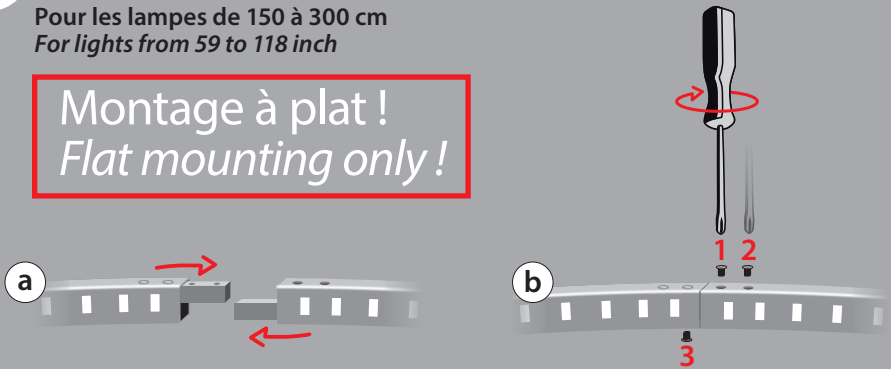

3

— Phase / Phase
— Neutre / Neutral
— Terre / Ground

x4

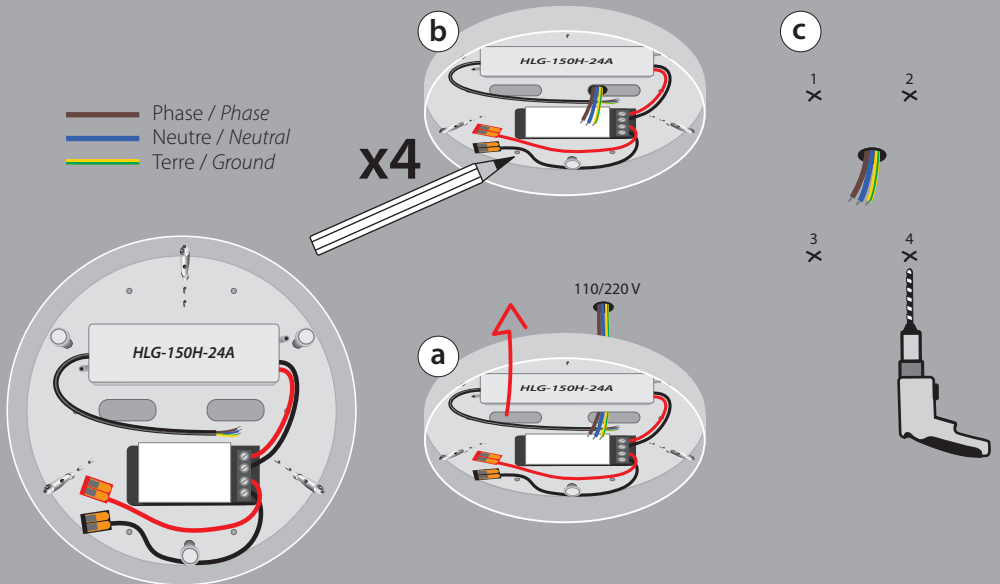

4

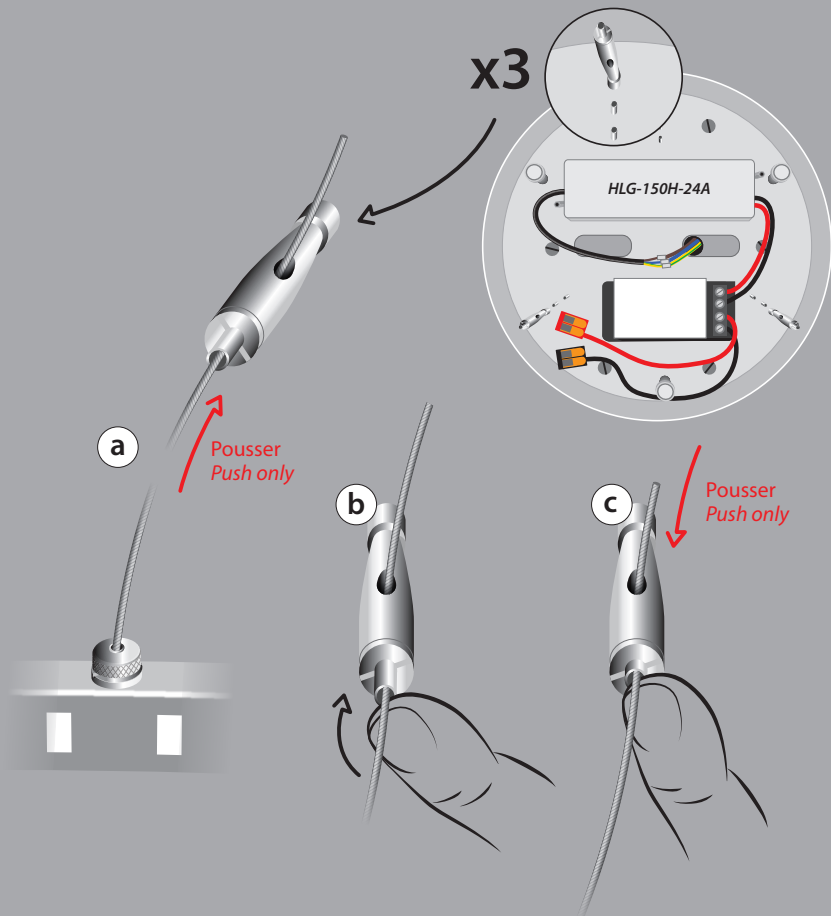

5

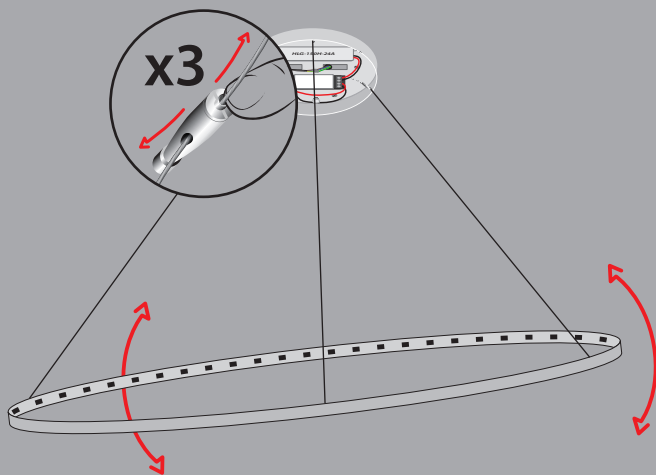

6

+1

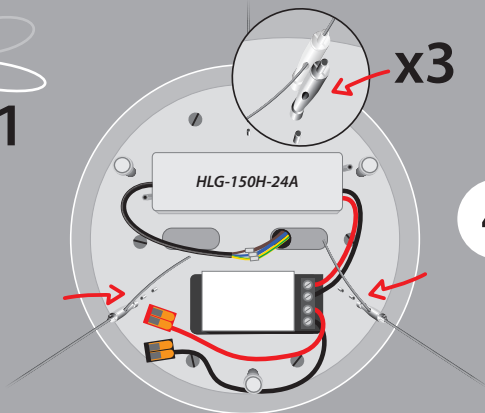

4

a + b + c

7

+1

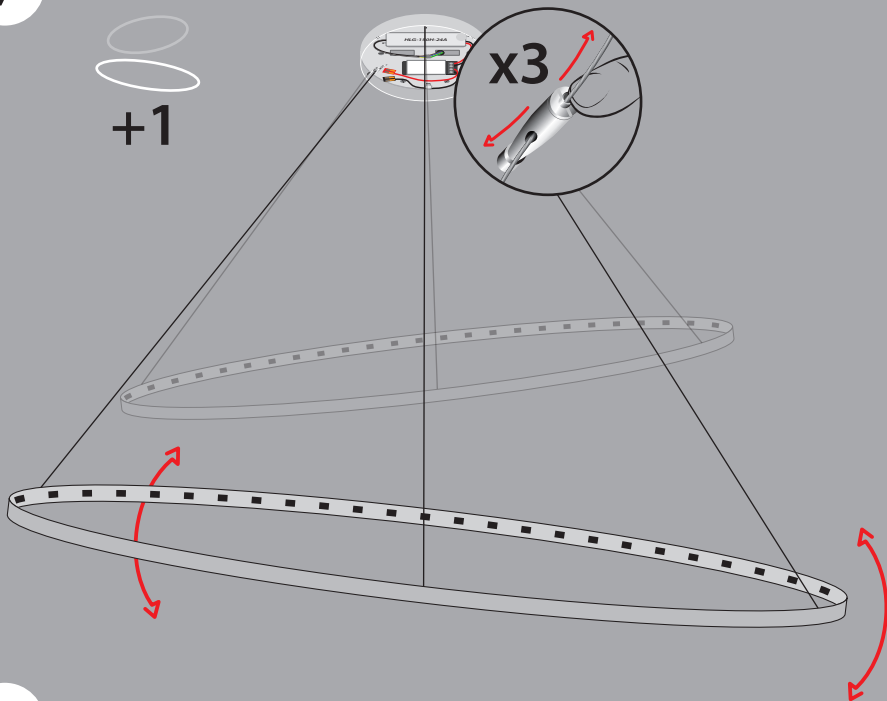

8

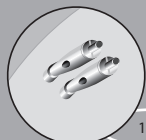

x2

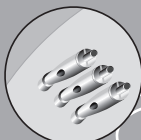

x3



x4



x5

9

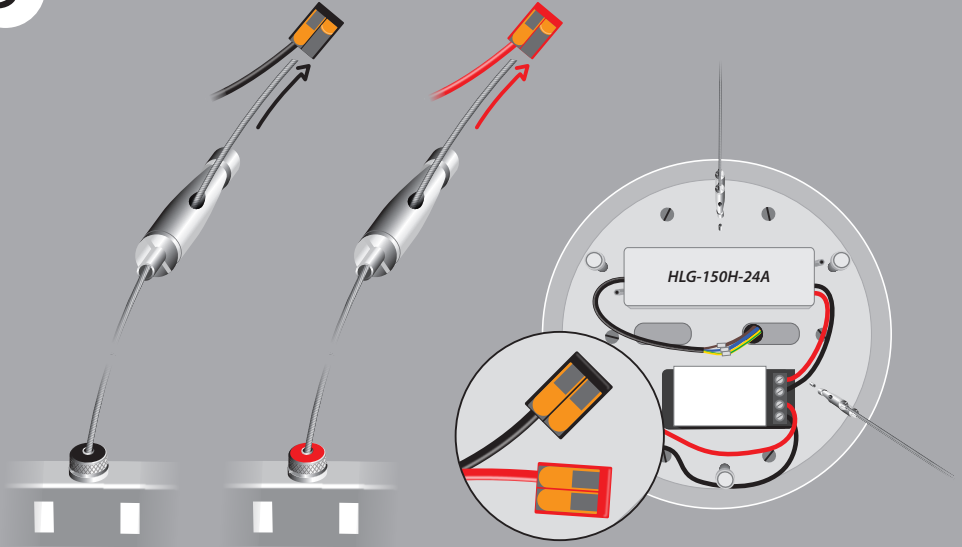

10

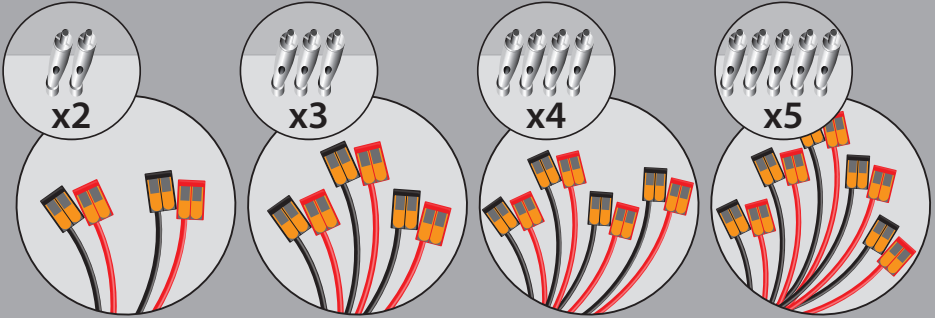

11

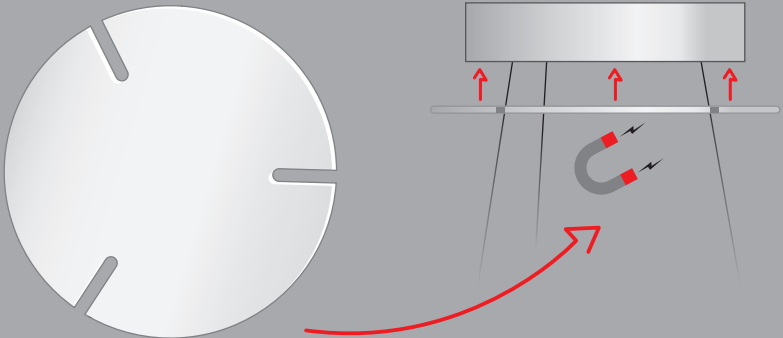

Lampes de 60 à 300 cm tous les 10 cm
Lights from 12 to 120 inch every 4 inch

300 cm - 120 inch

60 cm
12 inch

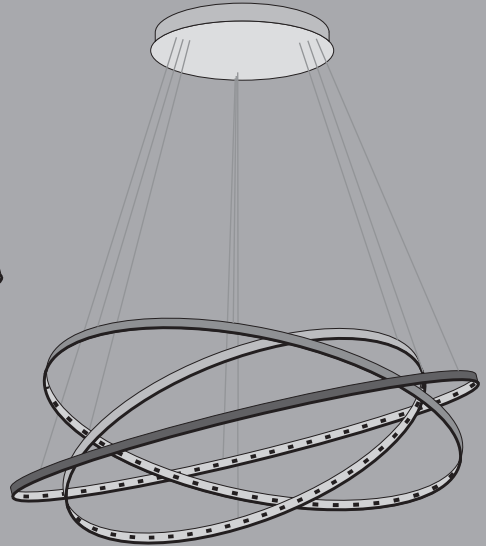
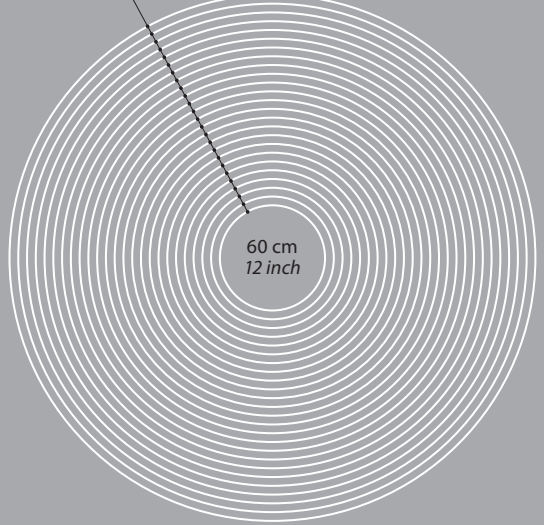
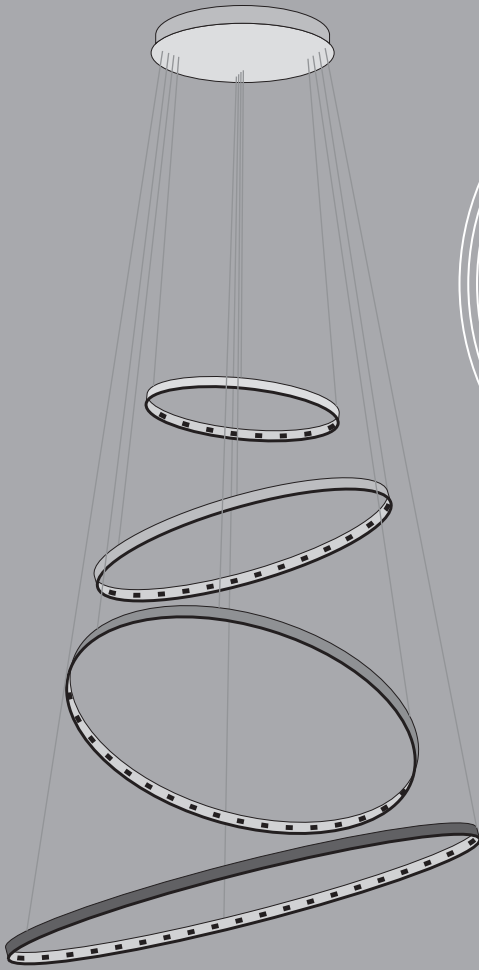

PRÉCAUTIONS / NETTOYAGE

Les LED sont fabriquées en céramique et craignent les chocs et l'humidité.
Pour le nettoyage, passez simplement un chiffon sec.
Ne pas installer la lampe dans un endroit humide comme une salle de bain.

CAUTIONS / CLEANING

Our LED are made of ceramic and are shock and moisture sensitive.
Can be cleaned with a dry cloth only.
Not suitable for wet areas.

www.ledeun.com

Pour toute question, merci de contacter le service après-vente / Any issue please contact after sales
sav@ledeun.com