



Le Deun
LUMINAIRES

MADE IN PARIS

Suspension Fitting system

Mode d'emploi - *Instructions*

Circle 30/60/80 - Oméga 120/200 - Oval 100 - Ava 90/150
C2 60/80/100 - Zetta 60/80/100 - Zepto air - Super 8
Ultra 8/8xs - Hexa 1/3/5 - Mateo air

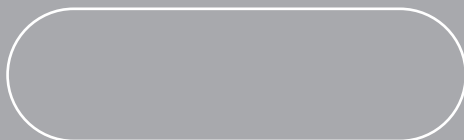

3 câbles / 3 wires



circle 30



circle 60



circle 80



mateo air

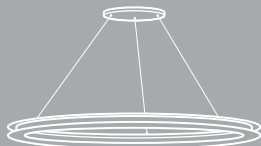

ava 90 / 150



c2 60 / 80 / 100

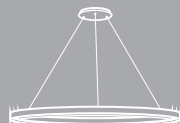

zetta 60 / 80 / 100



zepto air



omega 120

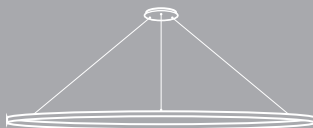

omega 200

4 câbles / 4 wires

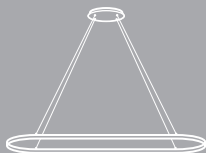

oval 100



super 8



ultra 8 xs

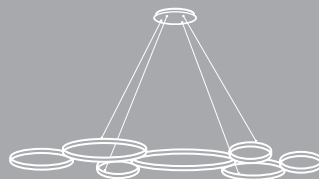

ultra 8



hexa 1



hexa 3

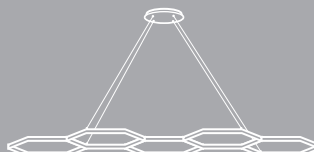

hexa 5

1

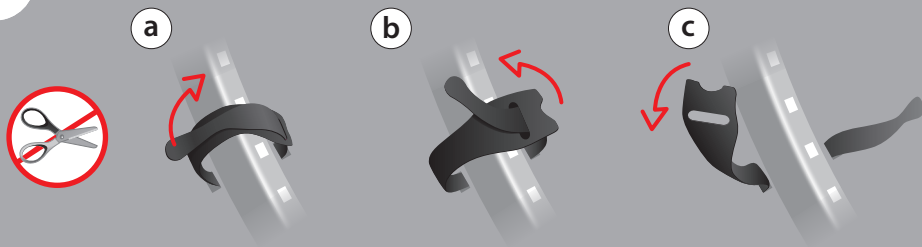

2 **omega 200**

Montage à plat !
Flat mounting only!

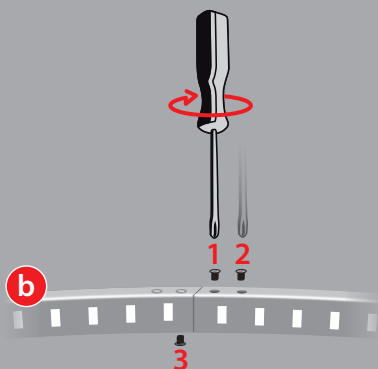
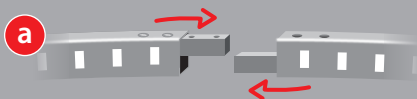

3

— Phase / Phase
— Neutre / Neutral

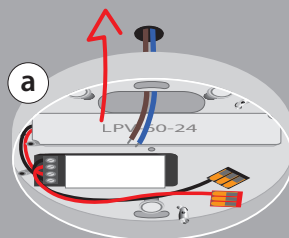
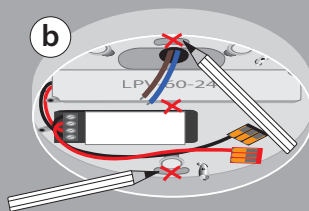
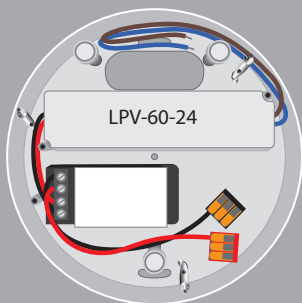

4

Introduire le câble ou réduire sa longueur
Insert the wire or reduce its length

Ne pas tirer le câble / Do not pull the cable
Pousser / Push only

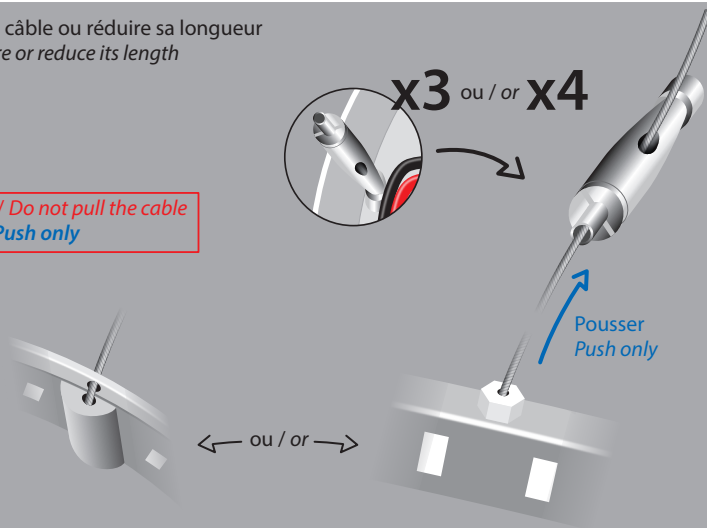

Pour rallonger le câble
To extend the wire

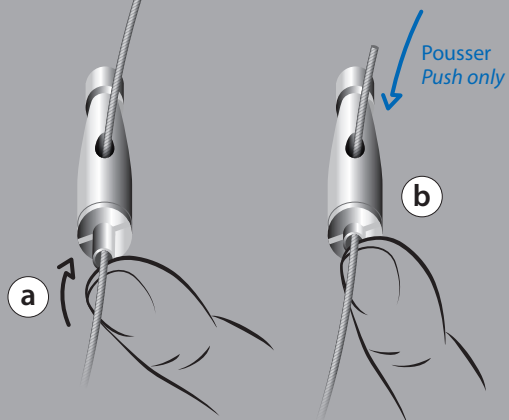

5

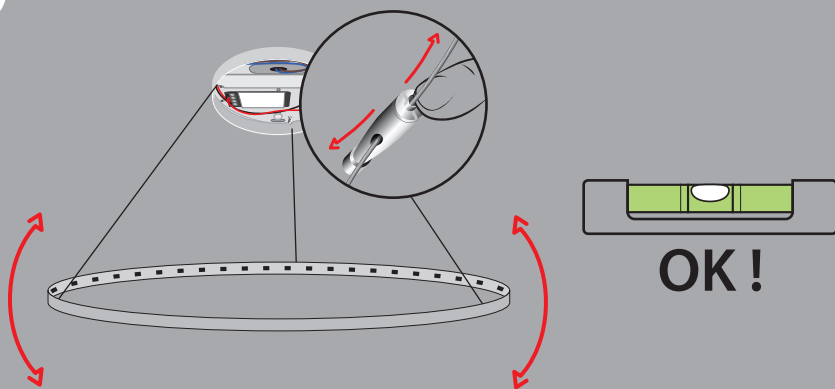

6

Récupéré de l'étape 1
Recovered from step 1

1

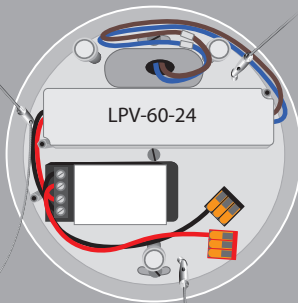
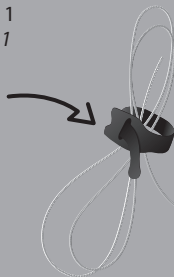

Ne pas couper le câble / Do not cut the wire

*Si vous coupez le câble, dénudez l'extrémité
Remove the plastic cover of the end of the wire
in case of you cut it*



7

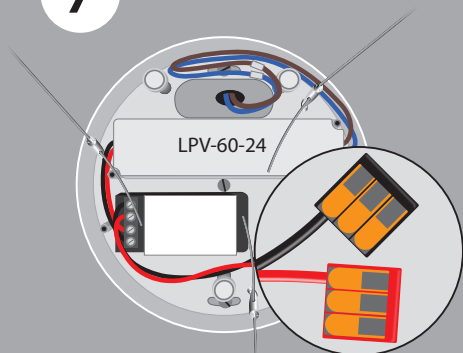

ou / or

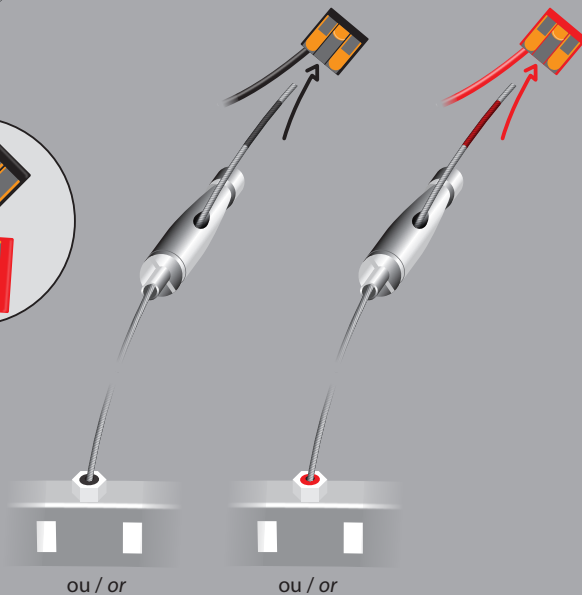
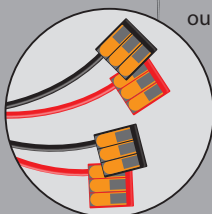

ou / or

ou / or

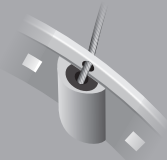

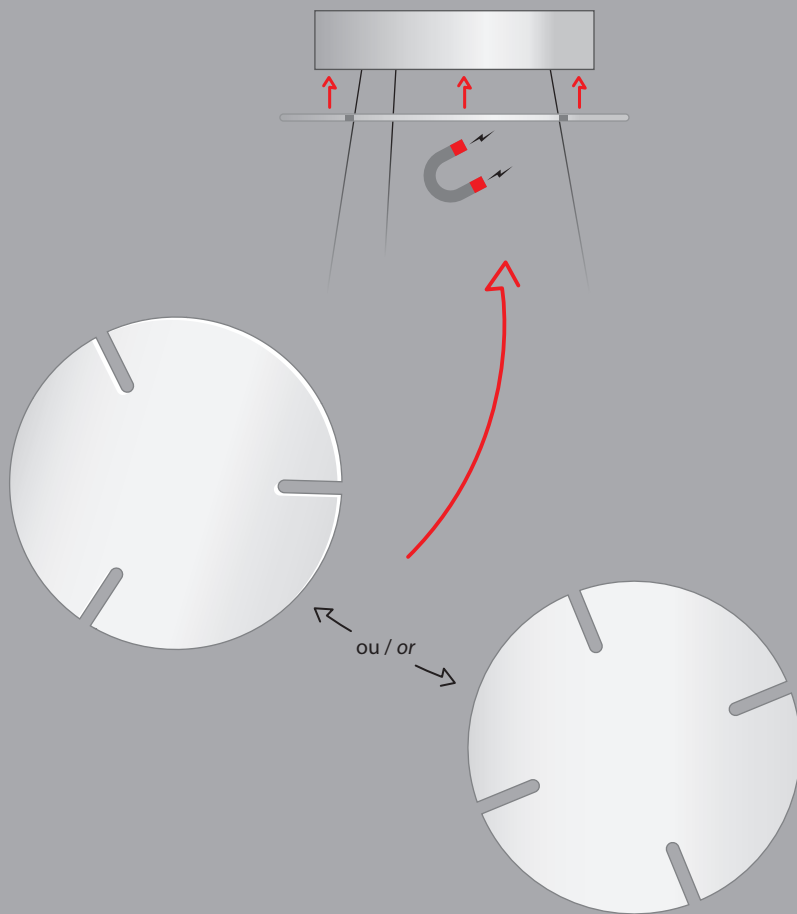
**PRÉCAUTIONS / NETTOYAGE**

Les LED sont fabriquées en céramique et craignent les chocs et l'humidité.
Pour le nettoyage, passez simplement un chiffon sec.
Ne pas installer la lampe dans un endroit humide comme une salle de bain.

CAUTIONS / CLEANING

*Our LED are made of ceramic and are shock and moisture sensitive.
Can be cleaned with a dry cloth only.
Not suitable for wet areas.*